

RP133 SPECIFICATIONS

VOLTAGE RATINGS	
Rated Frequency	50/60 Hz
Rated Maximum Line-to-Line Voltage, 3.0	1.5 RMS kV
Low Frequency Withstand Voltage	6.5 RMS kV
BIL Withstand Voltage	30 crest kV
CURRENT RATINGS	
Rated Continuous Current	400 RMS A
Generated Heat Loss:	
@ 400 amps; 30 pounds added contact force	24 watts
Maximum Short Circuit Current (Symmetrical)	5800 RMS A
Asymmetry Ratio S. Maximum	1.0
30 Sec. Current Carrying Capability	1800 RMS A
Fuse Let Through Current (1/2 Cycle)	28,000 peak A
MECHANICAL DATA	
Interrupter Weight	0.65 ± 5% lbs.
Moving Contact Weight	0.21 ± 5% lbs.
Contact Force from Atmosphere Pressure	9.7 ± 25% lbs.
MECHANICAL REQUIREMENTS	
Contact Stroke, Maximum	0.090 in.
Opening Speed Average to .06 inch Gap	1.1-2.5 ft./sec.
Overtravel During Opening Maximum	0.125 in.
Closing Speed Average of last .03 inch	1.1-2.0 ft./sec.
Contact Bounce Duration, Max	0.002 sec.
Added Contact Force for 5800 A RMS symmetrical	30 lbs.
TYPICAL LIFE	
Contact Erosion Limit	0.04 inch
MECHANICAL LIFE	
ELECTRICAL LIFE	

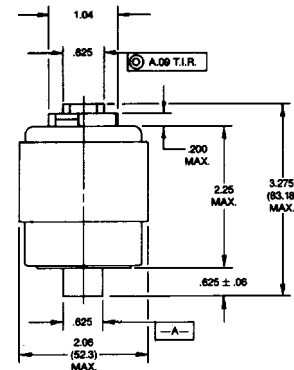
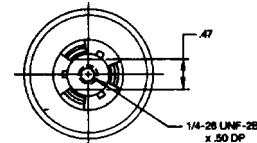

NOTES:

1. Avoid twisting movable terminal and excessive opening of contacts to prevent damage to bellows and reduced life.
2. Electrical connections should be made at copper terminals. Compression type fittings are recommended.
3. Interrupter should be mounted at fixed end by Fixed Copper Terminal.
4. ALL DIMENSIONS ARE IN INCHES WITH OUTSIDE DIMENSIONS ALSO IN METRIC.